

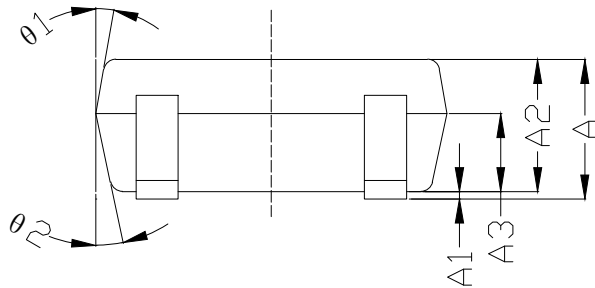

MARK	REVISION RECORD	REVISERE	APPROVER
△	修改文件名		
△			

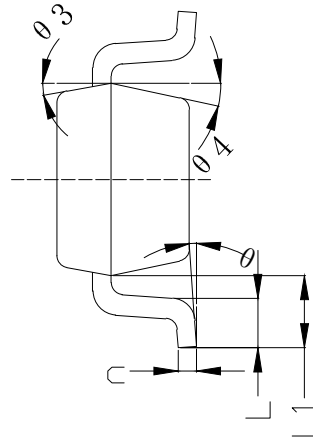
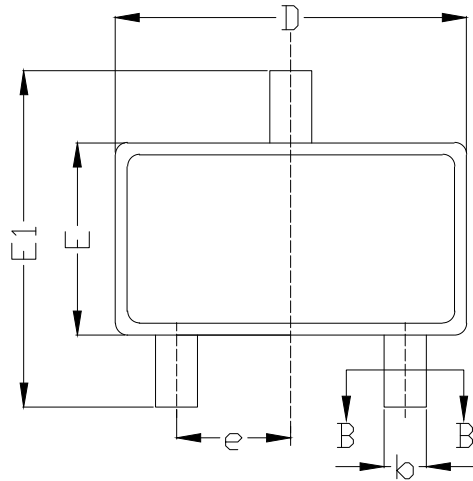

SYMBOL	MILLIMETER		
	MIN	NOM	MAX
A	--	--	1.25
A1	0.03	0.06	0.10
A2	1.00	1.10	1.20
A3	0.60	0.65	0.70
b	0.33	--	0.41
b1	0.32	0.35	0.38
c	0.15	--	0.17
c1	0.14	0.15	0.16
D	2.82	2.92	3.02
E	1.50	1.60	1.70
E1	2.60	2.80	3.00
e		0.95 BSC	
L	0.30	0.40	0.50
L1		0.60 REF	
θ	0°	--	6°
θ1	8°	--	12°
θ2	12°	--	14°
θ3	8°	--	12°
θ4	12°	--	14°

技术说明:

- 1) LEADFRAME MATERIAL: COPPER;
引线框架材料: 铜;
- 2) LEADFRAME THICKNESS: 0.152mm;
引线框架厚度: 0.152mm;
- 3) BOTH PACKAGE LENGTH AND WIDTH DO NOT INCLUDE MOLD FLASH;
塑封体长度及宽度尺寸不包括塑封溢胶;
- 4) REFERENCE: JEDEC MS-013, MS-012.
参考标准: JEDEC MS-013, MS-012.

 THIRD ANGLE PROJECTION	SCALE	UNIT	mm	TITLE
	DATE	2023-11-21		
TOLERANCE	DESIGNER	CHECKER	APPROVER	DWG.ND.
	张金萍			MT-PD-084
	2023-11-21			VERSION B 第1页 共1页